



Bentley Road, London, N1

BUTLER & STAG



Enviably located, just off Dalston Junction, is this immaculately presented one bedroom apartment. Occupying part of the second floor, accommodation comprises of an open-plan kitchen and living area, decent double bedroom and stylish modern bathroom. Being so close to varied transport links we feel this property would ideally suit a professional couple. Located at the heart of Dalston perfectly placed for access to Shoreditch, Islington and the City with the amenities of Kingsland Road on your doorstep. Available 13th August, part furnished.



- Second Floor
- One Bedroom
- Part Furnished
- Secure Development
- Close To Tube
- Immaculate Presentation







Second Floor

Approx. 45 sq. meters (484 sq. feet)

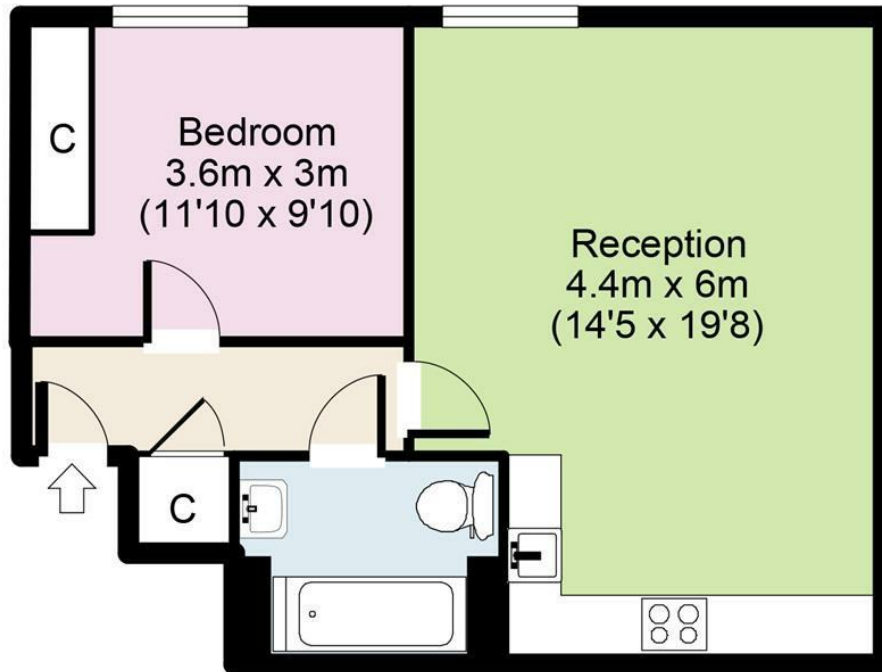

Total area: approx. 45 sq. meters (484 sq. feet)
For illustration purposes only - not to scale

BUTLER & STAG

☎ 020 8102 1236

🏠 508 Roman Road, Bow, London, E3 5LU

✉ bow@butlerandstag.com

IMPORTANT NOTICE - These particulars have been prepared in good faith and they are not intended to constitute part of an offer or contract. We have not performed a structural survey on this property and the services, appliances and specific fittings have not been tested. All photographs, measurements, floor plans and distances referred to are given as a guide and should not be relied upon.

www.butlerandstag.uk